

Grohtemp Thermostat Rough-In Valve

Paraffin cartridge

3/4" NPT

Built-in check valves and service stops

Temperature Control Only

Must use with separate volume control*

*See GROHE price list for volume control options

Requires twin ell 03.671 for shower/tub combination with diverter spout (not included)

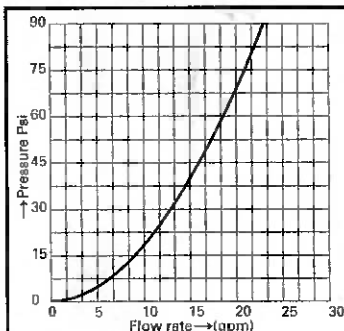

— Pressure loss curve without downstream resistance, temperature selector setting, 100°F.

Psi	15	30	45	60	75	90
q/min.	8.1	12.5	16	18	21	23

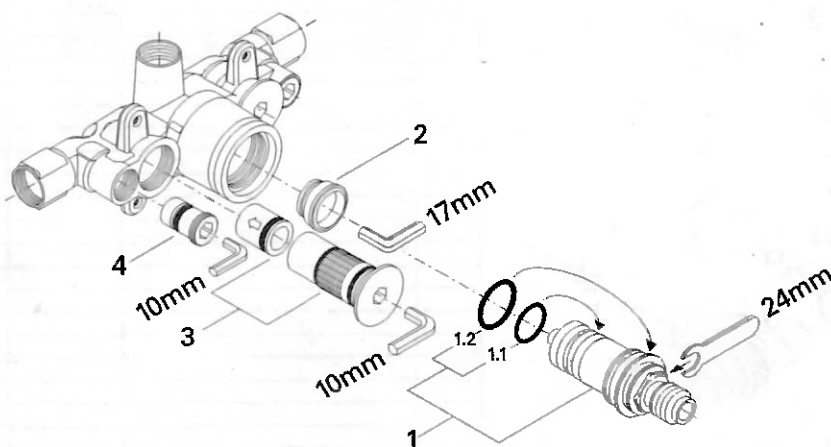
[illegible]